

totflex



Switch to Precision:
The Smart Choice For Level Control

Reflex Level Indicator – T -RLI

Totflex Reflex Level Indicator is a high-performance device designed for monitoring liquid levels in pressure tanks and high-temperature applications. It utilizes the principle of light refraction to differentiate between liquids and gases, offering a clear and reliable reading. Its robust design, comprising carbon steel or stainless steel, ensures durability under harsh conditions, making it suitable for industrial use.

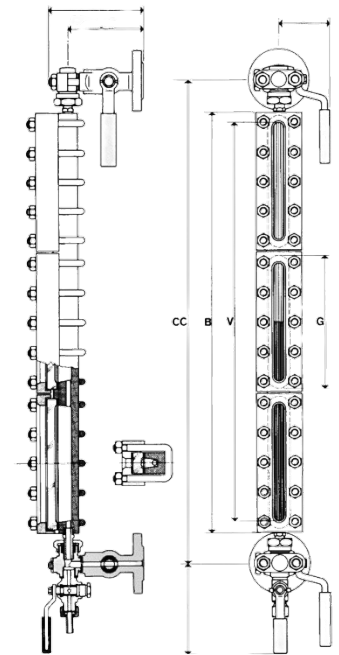
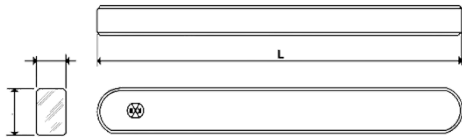

Working Principle:

Totflex Reflex Level Indicator operates on the principle of light refraction, allowing for a clear distinction between liquids and gases. This makes it an ideal tool for monitoring liquid levels in various industrial applications.

- **Light Refraction:** Differentiates liquids (dark appearance) from gases and vapors (bright appearance).
- **Thermal Resistance:** Designed to handle thermal shocks and temperature variations.
- **Limitations:** Not recommended for use with high-temperature alkaline solutions or hydrofluoric acid.

Advantages:

- **Economical:** Cost-effective solution for liquid level monitoring.
- **Easy to Read:** Provides clear visibility for accurate level assessment.
- **High-Pressure Capability:** Suitable for use in high-pressure steam applications.

Application Areas:

- **Steam Tanks:** Ideal for monitoring levels in steam applications.
- **Loading and Dumping Tanks:** Suitable for industrial loading and unloading processes.
- **Chemical Industry:** Effective in various chemical processing applications.
- **Petroleum Product Tanks:** Used in storage and handling of petroleum products.
- **Hygienic Load Tanks:** Applicable in industries requiring hygienic conditions.

Feature	Specification
Valves	T100 Transmission Steel
Reflex Glass	MAXOS
Rod Material	304-316 Stainless Steel
O-Ring	Graphite
Cover	ST37 Carbon Steel
Test Pressure	PN32 kg/cm ²
Operating Pressure	PN16 kg/cm ²
Max. Temperature	250°C